



BRIGHT LED ELECTRONICS CORP.

Total Page:5
Page: 1
Revision:1.4

●Device Number : BIR-BM1331

Sheet Date	1	2	3	4	5							Contents
2002.03.05	1.0	1.0	1.0	1.0	1.0							Initial Released
2002.03.13	1.1	1.1	-	-	-							Radiant Power
2002.05.15	1.2	1.2	-	-	-							Date, Ir, Vr
2002.12.17	1.3	1.3	1.1	-	-							Date, Ee, Notes
2003.04.05	1.4	1.4	1.1	1.1	-							Date, Tsol, Ee, Ie, VF, FIG.3

Total Page	5																		
------------	---	--	--	--	--	--	--	--	--	--	--	--	--	--	--	--	--	--	--

佰鴻工業股份有限公司

BRIGHT LED ELECTRONICS CORP.

台北縣板橋市和平路 19 號 3 樓
3F., No. 19, Ho Ping Road, Pan Chiao City,
Taipei, Taiwan, R. O. C.

Tel: 886-2-29591090

Fax: 886-2-29547006/29558809

www.brtled.com

Approved	Drawn

BRIGHT LED ELECTRONICS CORP.

●Device Number : BIR-BM1331

Page: 2

●Absolute Maximum Rating(Ta=25°C)

Version: 1.4

Item	Symbol	Rating	Unit
Reverse Voltage	V _r	5	V
Reverse Current	I _r	100	μA
Power Dissipation	P _d	100	mW
Forward Current	I _f	100	mA
Peak Forward Current(*1)	I _{fp}	1.0	A
Operating Temperature	T _{opr}	-45 ~ +85	°C
Storage Temperature	T _{stg}	-45 ~ +100	°C
Soldering Temperature(*2)	T _{sol}	260	°C

(*1)、Pulse Width=10μs,10%Duty Cycle

(*2)、For 5 Sec

●Electrical And Optical Characteristics(Ta=25°C)

Parameter	Symbol	Condition	Min.	Typ.	Max.	Unit
Forward Voltage	V _f	I _f =50mA	—	1.2	1.5	V
Spectral Line Half-Width	Δλ	I _f =20mA	—	50	—	nm
Radiant Power	E _e	I _f =50mA	0.9	3.6	—	mW/cm ²
	I _e	I _f =50mA	6.0	23.8	—	mW/sr
Viewing Angle	2θ 1/2	I _f =20mA	—	30	—	deg
Peak Wavelength	λ _p	I _f =20mA	—	940	—	nm
Rise Time	T _r	I _{fp} =20mA, R _i =1kΩ	—	500	—	ns
Fall Time	T _f		—	500	—	ns

BRIGHT LED ELECTRONICS CORP.

●Device Number: BIR-BM1331

Page: 3

●Dimensions

Version: 1.1

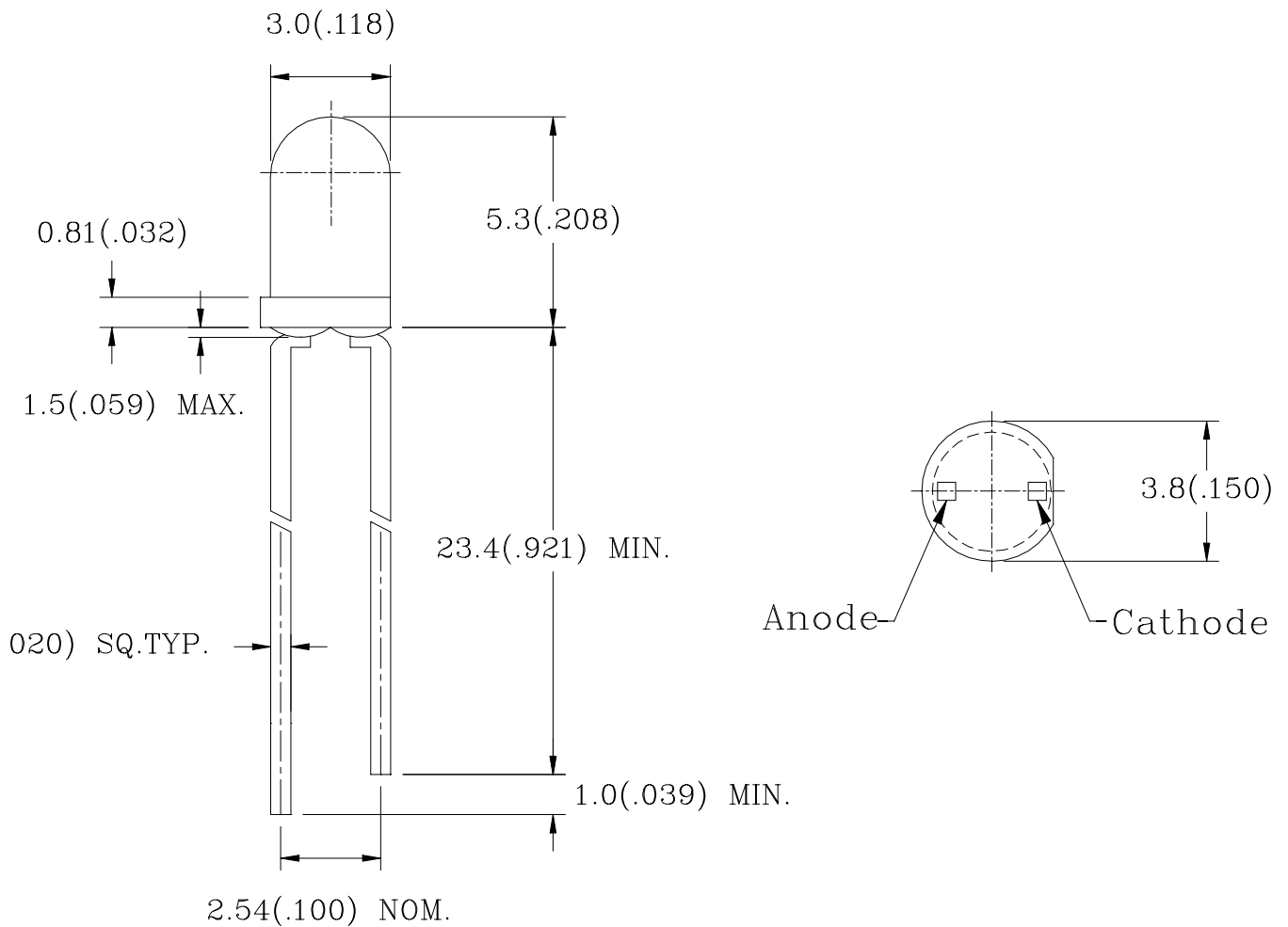

Notes:

- 1、All dimensions are in millimeters(inches).
- 2、Tolerance is $\pm 0.25\text{mm}(0.01'')$ unless otherwise specified.
- 3、Lead spacing is measured where the leads emerge from the package.
- 4、Specifications are subject to change without notice.
- 5.Lens Appearance: water clear.

BRIGHT LED ELECTRONICS CORP.

● Device Number: BIR-BM1331

Page: 4

● Electrical And Optical Curves(Ta=25°C)

Version: 1.1

FIG.1 Spectral Distribution

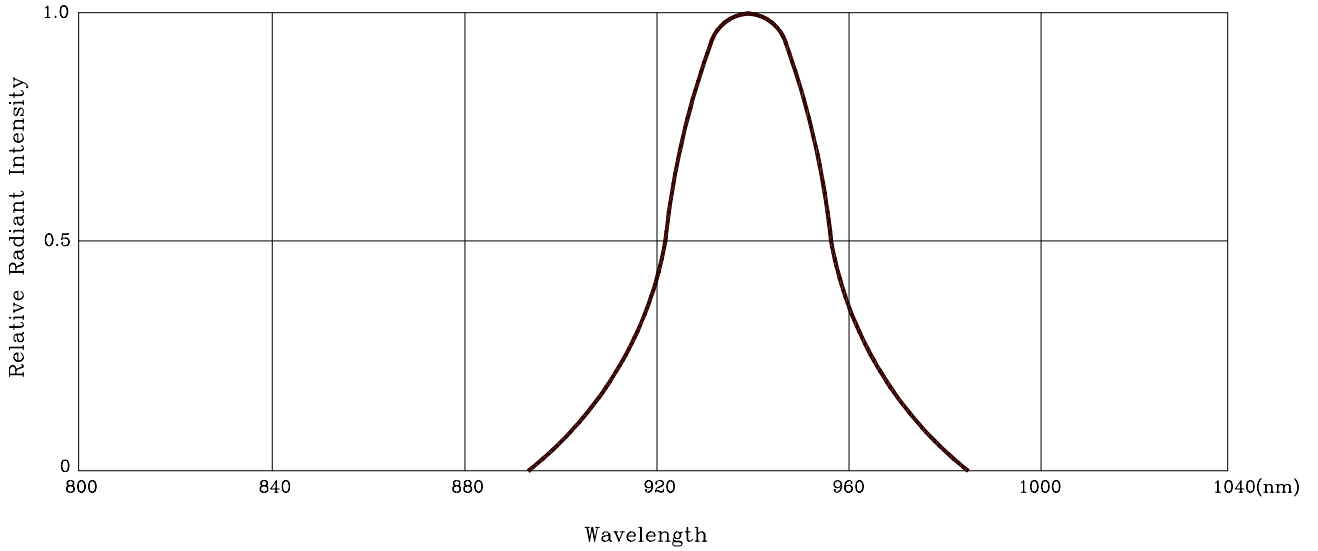

FIG.2 Forward Current Vs. Forward Voltage

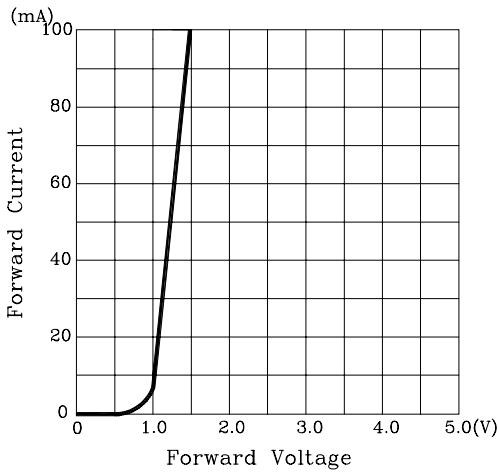

FIG.3 Relative Radiant Intensity Vs. Ambient Temperature

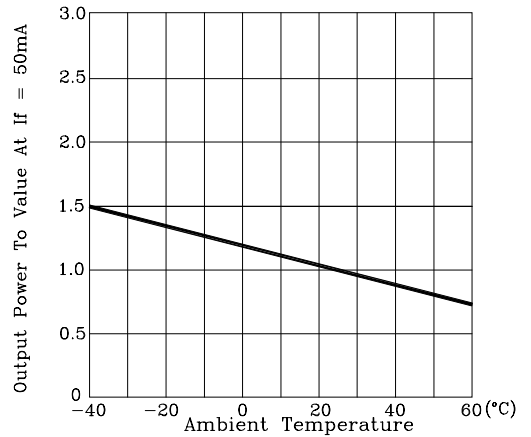

FIG.4 Relative Radiant Vs. Forward Current

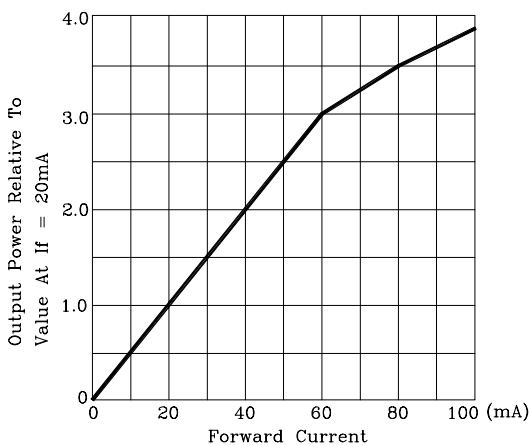
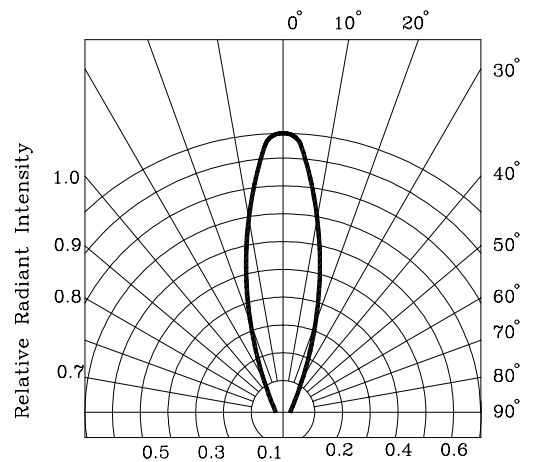

FIG.5 Radiant Diagram



BRIGHT LED ELECTRONICS CORP.

●Device Number: BIR-BM1331

Page: 5

●Packaging Box Dimensions

Version: 1.0

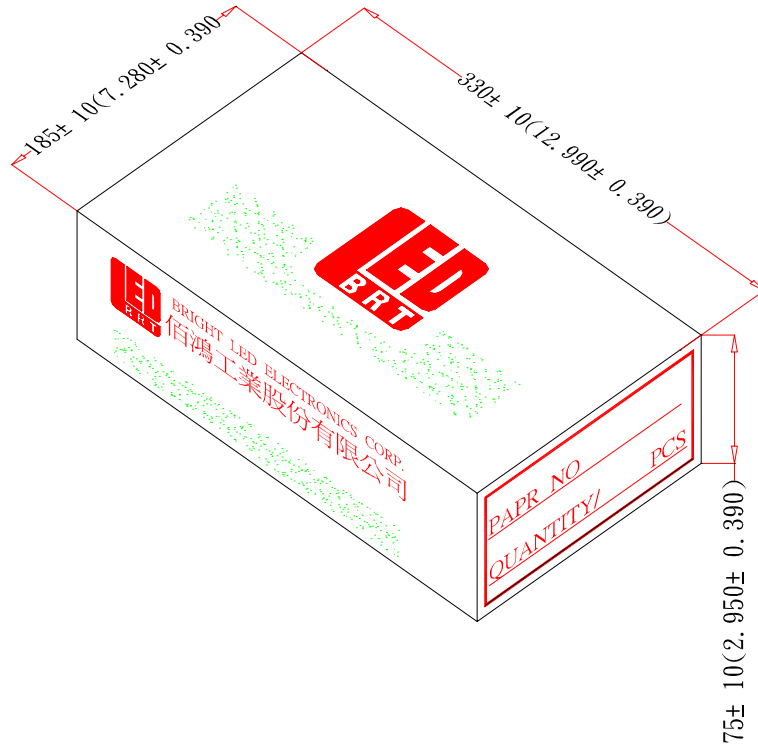

●Packaging Bag Dimensions

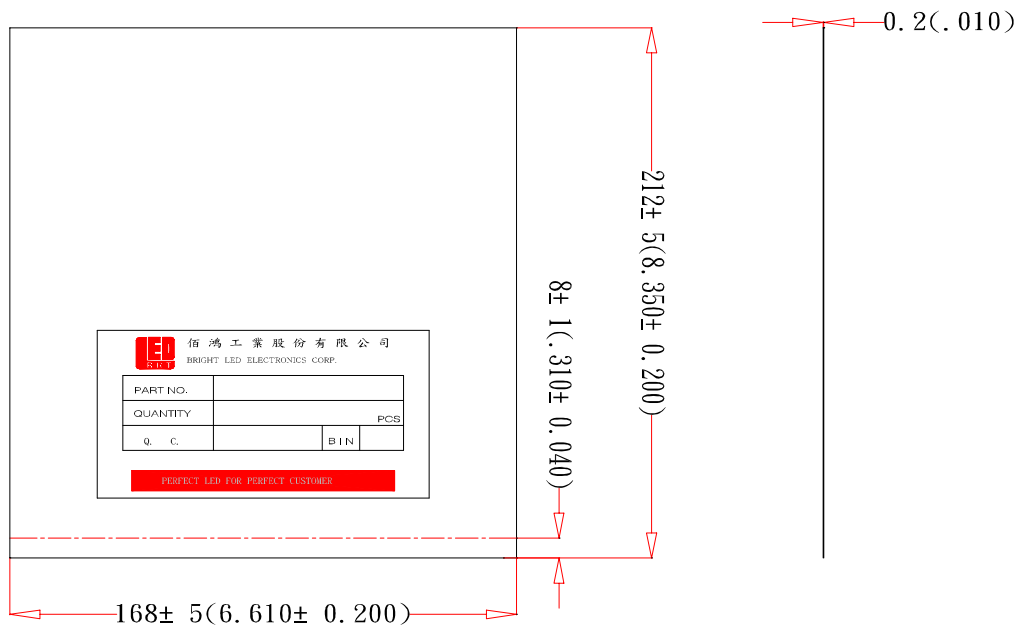

Notes:

- 1、1Kpcs per bag, 8Kpcs per box.
- 2、All dimensions are in millimeters(inches).
- 3、Specifications are subject to change without notice.