

MULTI-PURPOSE,RFI/EMI DIE -CAST ALUMINIUM BOX WITH MOUNTING FLANGE

G0XXX-F
SERIES

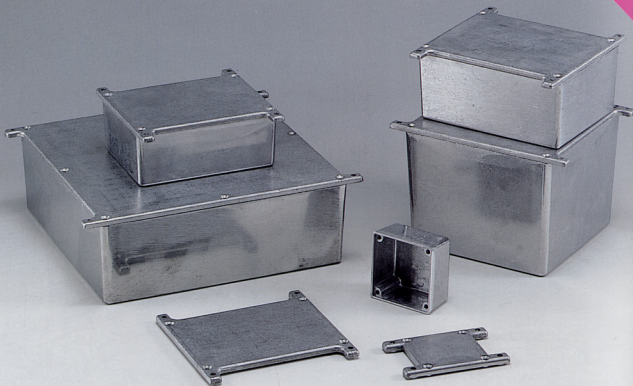

THESE NEW DIE-CAST ALUMINIUM BOXES ARE THE BEST QUALITY AND FINISH COMPARED WITH OTHER EUROPEAN AND NORTH AMERICAN MADE SIMILAR BOXES. WHY DON'T YOU PAY LESS TO GET BETTER QUALITY SIMILAR BOXES? WE THINK THE DECISION IS EASY FOR YOU TO MAKE.

- ALUMINIUM DIE-CAST BOXES MOULDED TO 380 ALUMINIUM ALLOY (BS1490 LM24).
- IDEAL FOR RF PROJECTS OR FOR PROJECTS WHICH ARE SUBJECT TO WEATHER.
- ROBUST, LIGHT WEIGHT AND EASY TO MACHINE.
- IDEAL FOR PROJECTS INVOLVING HEAT AS THE CASE ITSELF MAKES AN EXCELLENT HEATSINK.

APPLICATION:

- INSTRUMENT.
- METER CASE.
- FILTER NETWORKS.
- JUNCTION BOX.

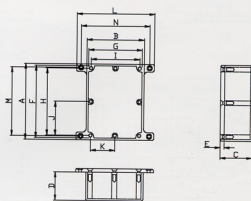

DETAILED DIMENSION IN mm

PART NO.	A	B	C	D	E	F	G	H	I	J	K	L	M	N
G0478F	190.5	190.5	66.5	62.5	4.0	185.7	185.7	180.6	180.6	90.3	90.3	215.5	180.9	202.5

STOCK NO.	EXTERNAL DIMENSION (mm)		
	WIDTH	DEPTH	HEIGHT
G0123F	90.0	38.0	30.0
G0124F	111.0	60.0	30.0
G0234F	119.0	93.5	56.5
G0247F	187.0	118.0	56.5
G0347F	187.0	118.0	81.7
G0470F	50.8	50.8	31.8
G0471F	110.0	82.5	44.5
G0472F	120.5	80.0	59.2
G0473F	119.0	93.5	34.0
G0474F	120.5	120.5	59.2
G0475F	120.5	120.5	95.2
G0476F	152.4	82.5	50.8
G0477F	187.0	118.0	38.0
G0478F	190.5	190.5	66.5
G0479F	111.0	60.0	54.0

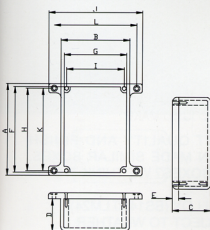

DETAILED DIMENSION IN mm

PART NO.	A	B	C	D	E	F	G	H	I	J	K	L
G0123F	90.0	38.0	30.0	26.0	4.0	86.0	34.0	82.0	28.0	63.1	82.8	50.0
G0124F	111.0	60.0	30.0	26.0	4.0	107.2	56.2	101.6	50.8	84.5	101.3	72.1
G0234F	119.0	93.5	56.5	52.5	4.0	114.2	88.7	109.5	84.2	118.5	105.6	104.7
G0470F	50.8	50.8	31.8	27.8	4.0	47.4	47.4	41.2	41.2	75.8	41.4	62.8
G0471F	110.0	82.5	44.5	40.5	4.0	105.2	77.7	100.5	73.0	107.5	100.7	94.7
G0472F	120.5	80.0	59.2	55.2	4.0	115.7	75.2	111.1	70.5	105.0	111.3	92.1
G0473F	119.0	93.5	34.0	30.0	4.0	114.2	88.7	109.5	84.2	118.5	105.6	104.7
G0474F	120.5	120.5	59.2	55.2	4.0	115.7	115.7	111.1	111.1	145.4	111.4	132.5
G0475F	120.5	120.5	95.2	91.2	4.0	115.7	115.7	111.1	111.1	145.4	111.4	132.5
G0479F	111.0	60.0	54.0	50.0	4.0	107.2	56.2	101.6	50.8	84.5	101.3	72.1

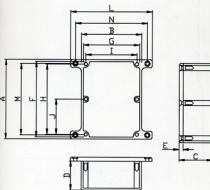

DETAILED DIMENSION IN mm

PART NO.	A	B	C	D	E	F	G	H	I	J	K	L	M
G0247F	187.0	118.0	56.5	52.5	4.0	182.2	113.2	177.8	109.5	88.9	143.0	178.2	130.0
G0347F	187.0	118.0	81.7	77.7	4.0	182.2	113.2	177.8	109.5	88.9	143.0	178.2	130.0
G0476F	152.4	82.5	50.8	46.8	4.0	147.6	77.7	142.5	72.6	71.3	107.5	142.7	94.6
G0477F	187.0	118.0	38.0	34.0	4.0	182.2	113.2	177.8	109.5	88.9	143.0	178.2	130.0